

# HDPE spie-eind hulpstukken





## HDPE NAADLOZE BOCHTEN 90 GRADEN

### SDR 17

Dia. / mm	Artikelcode
50 mm	50010090050
63 mm	50010090063
75 mm	50010090075
90 mm	50010090090
110 mm	50010090110
125 mm	50010090125
140 mm	50010090140
160 mm	50010090160
180 mm	50010090180
200 mm	50010090200
225 mm	50010090225
250 mm	50010090250
280 mm	50010090280
315 mm	50010090315
355 mm	50010090355
400 mm	50010090400
450 mm	50010090450
500 mm	50010090500
560 mm	50010090560
630 mm	50010090630
710 mm	50010090710
800 mm	50010090800
900 mm	50010090900

### SDR 13,6

Dia. / mm	Artikelcode
50 mm	60010090050
63 mm	60010090063
75 mm	60010090075
90 mm	60010090090
110 mm	60010090110
125 mm	60010090125
140 mm	60010090140
160 mm	60010090160
180 mm	60010090180
200 mm	60010090200
225 mm	60010090225
250 mm	60010090250
280 mm	60010090280
315 mm	60010090315
355 mm	60010090355
400 mm	60010090400
450 mm	60010090450
500 mm	60010090500
560 mm	60010090560
630 mm	60010090630
710 mm	60010090710
800 mm	60010090800
900 mm	60010090900

### SDR 11

Dia. / mm	Artikelcode
50 mm	70010090050
63 mm	70010090063
75 mm	70010090075
90 mm	70010090090
110 mm	70010090110
125 mm	70010090125
140 mm	70010090140
160 mm	70010090160
180 mm	70010090180
200 mm	70010090200
225 mm	70010090225
250 mm	70010090250

### SDR 11

Dia. / mm	Artikelcode
280 mm	70010090280
315 mm	70010090315
355 mm	70010090355
400 mm	70010090400
450 mm	70010090450
500 mm	70010090500
560 mm	70010090560
630 mm	70010090630
710 mm	70010090710
800 mm	70010090800
900 mm	70010090900



## HDPE NAADLOZE BOCHTEN 60 GRADEN

### SDR 17

Dia. / mm	Artikelcode
50 mm	50010060050
63 mm	50010060063
75 mm	50010060075
90 mm	50010060090
110 mm	50010060110
125 mm	50010060125
140 mm	50010060140
160 mm	50010060160
180 mm	50010060180
200 mm	50010060200
225 mm	50010060225
250 mm	50010060250
280 mm	50010060280
315 mm	50010060315
355 mm	50010060355
400 mm	50010060400
450 mm	50010060450
500 mm	50010060500
560 mm	50010060560
630 mm	50010060630
710 mm	50010060710
800 mm	50010060800
900 mm	50010060900

### SDR 13,6

Dia. / mm	Artikelcode
50 mm	60010060050
63 mm	60010060063
75 mm	60010060075
90 mm	60010060090
110 mm	60010060110
125 mm	60010060125
140 mm	60010060140
160 mm	60010060160
180 mm	60010060180
200 mm	60010060200
225 mm	60010060225
250 mm	60010060250
280 mm	60010060280
315 mm	60010060315
355 mm	60010060355
400 mm	60010060400
450 mm	60010060450
500 mm	60010060500
560 mm	60010060560
630 mm	60010060630
710 mm	60010060710
800 mm	60010060800
900 mm	60010060900

### SDR 11

Dia. / mm	Artikelcode
50 mm	70010060050
63 mm	70010060063
75 mm	70010060075
90 mm	70010060090
110 mm	70010060110
125 mm	70010060125
140 mm	70010060140
160 mm	70010060160
180 mm	70010060180
200 mm	70010060200
225 mm	70010060225
250 mm	70010060250

### SDR 11

Dia. / mm	Artikelcode
280 mm	70010060280
315 mm	70010060315
355 mm	70010060355
400 mm	70010060400
450 mm	70010060450
500 mm	70010060500
560 mm	70010060560
630 mm	70010060630
710 mm	70010060710
800 mm	70010060800
900 mm	70010060900



## HDPE NAADLOZE BOCHTEN 45 GRADEN

### SDR 17

Dia. / mm	Artikelcode
50 mm	50010045050
63 mm	50010045063
75 mm	50010045075
90 mm	50010045090
110 mm	50010045110
125 mm	50010045125
140 mm	50010045140
160 mm	50010045160
180 mm	50010045180
200 mm	50010045200
225 mm	50010045225
250 mm	50010045250
280 mm	50010045280
315 mm	50010045315
355 mm	50010045355
400 mm	50010045400
450 mm	50010045450
500 mm	50010045500
560 mm	50010045560
630 mm	50010045630
710 mm	50010045710
800 mm	50010045800
900 mm	50010045900

### SDR 13,6

Dia. / mm	Artikelcode
50 mm	60010045050
63 mm	60010045063
75 mm	60010045075
90 mm	60010045090
110 mm	60010045110
125 mm	60010045125
140 mm	60010045140
160 mm	60010045160
180 mm	60010045180
200 mm	60010045200
225 mm	60010045225
250 mm	60010045250
280 mm	60010045280
315 mm	60010045315
355 mm	60010045355
400 mm	60010045400
450 mm	60010045450
500 mm	60010045500
560 mm	60010045560
630 mm	60010045630
710 mm	60010045710
800 mm	60010045800
900 mm	60010045900

### SDR 11

Dia. / mm	Artikelcode
50 mm	70010045050
63 mm	70010045063
75 mm	70010045075
90 mm	70010045090
110 mm	70010045110
125 mm	70010045125
140 mm	70010045140
160 mm	70010045160
180 mm	70010045180
200 mm	70010045200
225 mm	70010045225
250 mm	70010045250

### SDR 11

Dia. / mm	Artikelcode
280 mm	70010045280
315 mm	70010045315
355 mm	70010045355
400 mm	70010045400
450 mm	70010045450
500 mm	70010045500
560 mm	70010045560
630 mm	70010045630
710 mm	70010045710
800 mm	70010045800
900 mm	70010045900



## HDPE NAADLOZE BOCHTEN 30 GRADEN

### SDR 17

Dia. / mm	Artikelcode
50 mm	50010030050
63 mm	50010030063
75 mm	50010030075
90 mm	50010030090
110 mm	50010030110
125 mm	50010030125
140 mm	50010030140
160 mm	50010030160
180 mm	50010030180
200 mm	50010030200
225 mm	50010030225
250 mm	50010030250
280 mm	50010030280
315 mm	50010030315
355 mm	50010030355
400 mm	50010030400
450 mm	50010030450
500 mm	50010030500
560 mm	50010030560
630 mm	50010030630
710 mm	50010030710
800 mm	50010030800
900 mm	50010030900

### SDR 13,6

Dia. / mm	Artikelcode
50 mm	60010030050
63 mm	60010030063
75 mm	60010030075
90 mm	60010030090
110 mm	60010030110
125 mm	60010030125
140 mm	60010030140
160 mm	60010030160
180 mm	60010030180
200 mm	60010030200
225 mm	60010030225
250 mm	60010030250
280 mm	60010030280
315 mm	60010030315
355 mm	60010030355
400 mm	60010030400
450 mm	60010030450
500 mm	60010030500
560 mm	60010030560
630 mm	60010030630
710 mm	50010030710
800 mm	50010030800
900 mm	50010030900

### SDR 11

Dia. / mm	Artikelcode
50 mm	70010030050
63 mm	70010030063
75 mm	70010030075
90 mm	70010030090
110 mm	70010030110
125 mm	70010030125
140 mm	70010030140
160 mm	70010030160
180 mm	70010030180
200 mm	70010030200
225 mm	70010030225
250 mm	70010030250

### SDR 11

Dia. / mm	Artikelcode
280 mm	70010030280
315 mm	70010030315
355 mm	70010030355
400 mm	70010030400
450 mm	70010030450
500 mm	70010030500
560 mm	70010030560
630 mm	70010030630
710 mm	70010030710
800 mm	70010030800
900 mm	70010030900

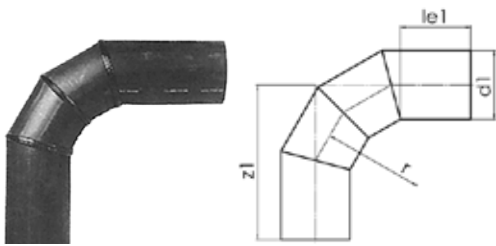

## HDPE SEGMENT GELASTE BOCHTEN 90 GRADEN

### SDR 17

Dia. / mm	Artikelcode
110 mm	51010090110
125 mm	51010090125
140 mm	51010090140
160 mm	51010090160
180 mm	51010090180
200 mm	51010090200
225 mm	51010090225
250 mm	51010090250
280 mm	51010090280
315 mm	51010090315
355 mm	51010090355
400 mm	51010090400
450 mm	51010090450
500 mm	51010090500
560 mm	51010090560
630 mm	51010090630
710 mm	51010090710
800 mm	51010090800
900 mm	51010090900
1000 mm	510100901000

### SDR 13,6

Dia. / mm	Artikelcode
110 mm	61010090110
125 mm	61010090125
140 mm	61010090140
160 mm	61010090160
180 mm	61010090180
200 mm	61010090200
225 mm	61010090225
250 mm	61010090250
280 mm	61010090280
315 mm	61010090315
355 mm	61010090355
400 mm	61010090400
450 mm	61010090450
500 mm	61010090500
560 mm	61010090560
630 mm	61010090630
710 mm	61010090710
800 mm	61010090800

### SDR 11

Dia. / mm	Artikelcode
110	71010090110
125	71010090125
140	71010090140
160	71010090160
180	71010090180
200	71010090200
225	71010090225
250	71010090250
280	71010090280
315	71010090315
355	71010090355
400	71010090400
450	71010090450
500	71010090500
560	71010090560
630	71010090630



## HDPE SEGMENT GELASTE BOCHTEN 60 GRADEN

### SDR 17

Dia. / mm	Artikelcode
110	51010060110
125	51010060125
140	51010060140
160	51010060160
180	51010060180
200	51010060200
225	51010060225
250	51010060250
280	51010060280
315	51010060315
355	51010060355
400	51010060400
450	51010060450
500	51010060500
560	51010060560
630	51010060630
710	51010060710
800	51010060800
900	51010060900
1000	510100601000

### SDR 13,6

Dia. / mm	Artikelcode
110	61010060110
125	61010060125
140	61010060140
160	61010060160
180	61010060180
200	61010060200
225	61010060225
250	61010060250
280	61010060280
315	61010060315
355	61010060355
400	61010060400
450	61010060450
500	61010060500
560	61010060560
630	61010060630
710	61010060710
800	61010060800

### SDR 11

Dia. / mm	Artikelcode
110	71010060110
125	71010060125
140	71010060140
160	71010060160
180	71010060180
200	71010060200
225	71010060225
250	71010060250
280	71010060280
315	71010060315
355	71010060355
400	71010060400
450	71010060450
500	71010060500
560	71010060560
630	71010060630



## HDPE SEGMENT GELASTE BOCHTEN 45 GRADEN

### SDR 17

Dia. / mm	Artikelcode
110	51010045110
125	51010045125
140	51010045140
160	51010045160
180	51010045180
200	51010045200
225	51010045225
250	51010045250
280	51010045280
315	51010045315
355	51010045355
400	51010045400
450	51010045450
500	51010045500
560	51010045560
630	51010045630
710	51010045710
800	51010045800
900	51010045900
1000	510100451000

### SDR 13,6

Dia. / mm	Artikelcode
110	61010045110
125	61010045125
140	61010045140
160	61010045160
180	61010045180
200	61010045200
225	61010045225
250	61010045250
280	61010045280
315	61010045315
355	61010045355
400	61010045400
450	61010045450
500	61010045500
560	61010045560
630	61010045630
710	61010045710
800	61010045800

### SDR 11

Dia. / mm	Artikelcode
110	71010045110
125	71010045125
140	71010045140
160	71010045160
180	71010045180
200	71010045200
225	71010045225
250	71010045250
280	71010045280
315	71010045315
355	71010045355
400	71010045400
450	71010045450
500	71010045500
560	71010045560
630	71010045630





## HDPE SEGMENT GELASTE BOCHTEN 11 - 30 GRADEN

SDR 17	
Dia. / mm	Artikelcode
110	51010030110
125	51010030125
140	51010030140
160	51010030160
180	51010030180
200	51010030200
225	51010030225
250	51010030250
280	51010030280
315	51010030315
355	51010030355
400	51010030400
450	51010030450
500	51010030500
560	51010030560
630	51010030630
710	51010030710
800	51010030800
900	51010030900
1000	510100301000

SDR 13,6	
Dia. / mm	Artikelcode
110	61010030110
125	61010030125
140	61010030140
160	61010030160
180	61010030180
200	61010030200
225	61010030225
250	61010030250
280	61010030280
315	61010030315
355	61010030355
400	61010030400
450	61010030450
500	61010030500
560	61010030560
630	61010030630
710	61010030710
800	61010030800

SDR 11	
Dia. / mm	Artikelcode
110	71010030110
125	71010030125
140	71010030140
160	71010030160
180	71010030180
200	71010030200
225	71010030225
250	71010030250
280	71010030280
315	71010030315
355	71010030355
400	71010030400
450	71010030450
500	71010030500
560	71010030560
630	71010030630



## HDPE SEGMENT GELASTE T-STUKKEN 90 GRADEN

### SDR 17

Dia. / mm	Artikelcode
160	31030090160
180	31030090180
200	31030090200
225	31030090225
250	31030090250
280	31030090280
315	31030090315
355	31030090355
400	31030090400
450	31030090450
500	31030090500
560	31030090560
630	31030090630
710	31030090710
800	31030090800
900	31030090900
1000	310300901000

### SDR 13,6

Dia. / mm	Artikelcode
160	35030090160
180	35030090180
200	35030090200
225	35030090225
250	35030090250
280	35030090280
315	35030090315
355	35030090355
400	35030090400
450	35030090450
500	35030090500
560	35030090560
630	35030090630
710	35030090710

### SDR 11

Dia. / mm	Artikelcode
160	41030090160
180	41030090180
200	41030090200
225	41030090225
250	41030090250
280	41030090280
315	41030090315
355	41030090355
400	41030090400
450	41030090450
500	41030090500
560	41030090560
630	41030090630



## HDPE UITGEHALSTE T-STUKKEN 90 GRADEN

SDR 17	
Dia. / mm	Artikelcode
110/32	320100110032
110/40	320100110040
110/50	320100110050
110/63	320100110063
110/75	320100110075
125/32	320100125032
125/40	320100125040
125/50	320100125050
125/63	320100125063
125/75	320100125075
125/90	320100125090
140/32	320100140032
140/40	320100140040
140/50	320100140050
140/63	320100140063
140/75	320100140075
140/90	320100140090
140/110	320100140110
160/32	320100160032
160/40	320100160040
160/50	320100160050
160/63	320100160063
160/90	320100160090
160/110	320100160110
180/32	320100180032
180/40	320100180040
180/50	320100180050
180/63	320100180063
180/75	320100180075
180/90	320100180090
180/110	320100180110
180/125	320100180125
200/32	320100200032
200/40	320100200040
200/50	320100200050
200/63	320100200063
200/75	320100200075
200/90	320100200090
200/110	320100200110
200/125	320100200125
200/140	320100200140
225/63	320100225063
225/75	320100225075
225/90	320100225090
225/110	320100225110

SDR 13,6	
Dia. / mm	Artikelcode
110/32	360100110032
110/40	360100110040
110/50	360100110050
110/63	360100110063
110/75	360100110075
125/32	360100125032
125/40	360100125040
125/50	360100125050
125/63	360100125063
125/75	360100125075
125/90	360100125090
140/32	360100140032
140/40	360100140040
140/50	360100140050
140/63	360100140063
140/75	360100140075
140/90	360100140090
140/110	360100140110
160/32	360100160032
160/40	360100160040
160/50	360100160050
160/63	360100160063
160/90	360100160090
160/110	360100160110
180/32	360100180032
180/40	360100180040
180/50	360100180050
180/63	360100180063
180/75	360100180075
180/90	360100180090
180/110	360100180110
180/125	360100180125
200/32	360100200032
200/40	360100200040
200/50	360100200050
200/63	360100200063
200/75	360100200075
200/90	360100200090
200/110	360100200110
200/125	360100200125
200/140	360100200140
225/63	360100225063
225/75	360100225075
225/90	360100225090
225/110	360100225110



## HDPE UITGEHALSTE T-STUKKEN 90 GRADEN

SDR 17	
Dia. / mm	Artikelcode
225/125	320100225125
225/140	320100225140
250/75	320100250075
250/90	320100250090
250/110	320100250110
250/125	320100250125
250/140	320100250140
250/160	320100250160
250/180	320100250180
280/90	320100280090
280/110	320100280110
280/125	320100280125
280/140	320100280140
280/160	320100280160
280/180	320100280180
280/200	320100280200
315/90	320100315090
315/110	320100315110
315/125	320100315125
315/140	320100315140
315/160	320100315160
315/180	320100315180
315/200	320100315200
315/225	320100315225
355/110	320100355110
355/140	320100355140
355/160	320100355160
355/180	320100355180
355/200	320100355200
355/225	320100355225
400/110	320100400110
400/125	320100400125
400/140	320100400140
400/160	320100400160
400/180	320100400180
400/200	320100400200
400/225	320100400225
400/250	320100400250
400/280	320100400280
450/110	320100450110
450/125	320100450125
450/140	320100450140
450/160	320100450160
450/180	320100450180
450/200	320100450200

SDR 13,6	
Dia. / mm	Artikelcode
225/125	360100225125
225/140	360100225140
250/75	360100250075
250/90	360100250090
250/110	360100250110
250/125	360100250125
250/140	360100250140
250/160	360100250160
250/180	360100250180
280/90	360100280090
280/110	360100280110
280/125	360100280125
280/140	360100280140
280/160	360100280160
280/180	360100280180
280/200	360100280200
315/90	360100315090
315/110	360100315110
315/125	360100315125
315/140	360100315140
315/160	360100315160
315/180	360100315180
315/200	360100315200
315/225	360100315225
355/110	360100355110
355/140	360100355140
355/160	360100355160
355/180	360100355180
355/200	360100355200
355/225	360100355225
400/110	360100400110
400/125	360100400125
400/140	360100400140
400/160	360100400160
400/180	360100400180
400/200	360100400200
400/225	360100400225
400/250	360100400250
400/280	360100400280
450/110	360100450110
450/125	360100450125
450/140	360100450140
450/160	360100450160
450/180	360100450180
450/200	360100450200



## HDPE UITGEHALSTE T-STUKKEN 90 GRADEN

SDR 17	
Dia. / mm	Artikelcode
450/225	320100450225
450/250	320100450250
450/280	320100450280
450/315	320100450315
500/110	320100500110
500/125	320100500125
500/140	320100500140
500/160	320100500160
500/180	320100500180
500/250	320100500250
500/280	320100500280
500/315	320100500315
500/355	320100500355
560/110	320100560110
560/125	320100560125
560/140	320100560140
560/160	320100560160
560/180	320100560180
560/200	320100560200
560/225	320100560225
560/250	320100560250
560/280	320100560280
560/315	320100560315
560/355	320100560355
560/400	320100560400
630/200	320100630200
630/225	320100630225
630/250	320100630250
630/280	320100630280
630/315	320100630315
630/355	320100630355
630/400	320100630400

SDR 13,6	
Dia. / mm	Artikelcode
450/225	360100450225
450/250	360100450250
450/280	360100450280
450/315	360100450315
500/110	360100500110
500/125	360100500125
500/140	360100500140
500/160	360100500160
500/180	360100500180
500/250	360100500250
500/280	360100500280
500/315	360100500315
500/355	360100500355
560/110	360100560110
560/125	360100560125
560/140	360100560140
560/160	360100560160
560/180	360100560180
560/200	360100560200
560/225	360100560225
560/250	360100560250
560/280	360100560280
560/315	360100560315
560/355	360100560355
560/400	360100560400
630/200	360100630200
630/225	360100630225
630/250	360100630250
630/280	360100630280
630/315	360100630315
630/355	360100630355
630/400	360100630400



## HDPE UITGEHALSTE T-STUKKEN 90 GRADEN

SDR 11	
Dia. / mm	Artikelcode
110/32	420100110032
110/40	420100110040
110/50	420100110050
110/63	420100110063
110/75	420100110075
125/32	420100125032
125/40	420100125040
125/50	420100125050
125/63	420100125063
125/75	420100125075
125/90	420100125090
140/32	420100140032
140/40	420100140040
140/50	420100140050
140/63	420100140063
140/75	420100140075
140/90	420100140090
140/110	420100140110
160/32	420100160032
160/40	420100160040
160/50	420100160050
160/63	420100160063
160/75	420100160075
160/90	420100160090
180/32	420100180032
180/40	420100180040
180/50	420100180050
180/63	420100180063
180/75	420100180075
180/90	420100180090
180/110	420100180110
180/125	420100180125
200/32	420100200032
200/40	420100200040
200/50	420100200050
200/63	420100200063
200/75	420100200075
200/90	420100200090
200/110	420100200110
200/125	420100200125
200/140	420100200140
225/63	420100225063
225/75	420100225075
225/90	420100225090
225/110	420100225110

SDR 11	
Dia. / mm	Artikelcode
225/125	420100225125
225/140	420100225140
225/160	420100225160
250/90	420100250090
250/110	420100250110
250/125	420100250125
250/140	420100250140
250/160	420100250160
250/180	420100250180
280/90	420100280090
280/110	420100280110
280/125	420100280125
280/140	420100280140
280/160	420100280160
280/180	420100280180
280/200	420100280200
315/90	420100315090
315/110	420100315110
315/125	420100315125
315/140	420100315140
315/160	420100315160
315/180	420100315180
315/200	420100315200
315/225	420100315225
355/110	420100355110
355/125	420100355125
355/140	420100355140
355/160	420100355160
355/180	420100355180
355/200	420100355200
355/225	420100355225
400/110	420100400110
400/125	420100400125
400/140	420100400140
400/160	420100400160
400/180	420100400180
400/200	420100400200
400/225	420100400225
400/250	420100400250
400/280	420100400280
450/110	420100450110
450/125	420100450125
450/140	420100450140
450/160	420100450160
450/180	420100450180



## HDPE UITGEHALSTE T-STUKKEN 90 GRADEN

SDR 11	
Dia. / mm	Artikelcode
450/200	420100450200
450/225	420100450225
450/250	420100450250
450/280	420100450280
450/315	420100450315
500/110	420100500110
500/125	420100500125
500/140	420100500140
500/160	420100500160
500/180	420100500180
500/200	420100500200
500/225	420100500225
500/250	420100500250
500/280	420100500280
500/315	420100500315
500/355	420100500355
560/110	420100560110
560/125	420100560125
560/140	420100560140
560/160	420100560160
560/180	420100560180
560/200	420100560200
560/225	420100560225
560/250	420100560250
560/280	420100560280
560/355	420100560355
560/400	420100560400
630/200	420100630200
630/225	420100630225
630/250	420100630250
630/280	420100630280
630/315	420100630315
630/355	420100630355
630/400	420100630400
630/450	420100630450



## HDPE MUUR- DOORVOERINGEN TREKFAST

SDR 17	
Dia. / mm	Artikelcode
90	970090
110	970110
125	970125
140	970140
160	970160
180	970180
200	970200
225	970225
250	970250
280	970280
315	970315
355	970355
400	970400
450	970450
500	970500
560	970560
630	970630
710	970710
800	970800
900	970900
1000	9701000

SDR 11	
Dia. / mm	Artikelcode
90	975090
110	975110
125	975125
140	975140
160	975160
180	975180
200	975200
225	975225
250	975250
280	975280
315	975315
355	975355
400	975400
450	975450
500	975500
560	975560
630	975630



## HDPE MUURDOOR- VOERINGEN DRUKWATER- EN TREKFAST INCL. VOORGEMONTEERDE EPDM-MUURKRAAG

SDR 17	
Dia. / mm	Artikelcode
90	980090
110	980110
125	980125
140	980140
160	980160
180	980180
200	980200
225	980225
250	980250
280	980280
315	980315
355	980355
400	980400
450	980450
500	980500
630	980630
710	980710
800	980800
900	980900
1000	9801000

SDR 11	
Dia. / mm	Artikelcode
90	985090
110	985110
125	985125
140	985140
160	985160
180	985180
200	985200
225	985225
250	985250
280	985280
315	985315
355	985355
400	985400
450	985450
500	985500
630	985630



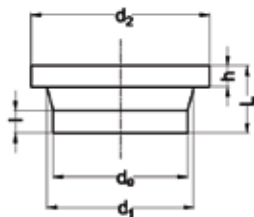

## HDPE spie-eind fittingen

- Voorlaskraag kort PE100
- SDR 17 voor stuiklas
- water 10 bar/gas 5 bar

SDR 17						
$d_e$	Art. Nr.	h	l	$d_1$	$d_2$	L
50	470502517	12	21	61	88	50
63	300100063	14	16	75	102	50
75	300100075	16	14	89	122	50
90	300100090	17	33	105	138	80
110	300100110	18	27	125	158	80
125	300100125	18	42	132	158	80
140	300100140	18	34	155	188	80
160	300100160	18	34	175	212	80
180	300100180	20	60	182	212	80
200	300100200	24	36	232	268	100
225	300100225	24	46	235	268	100
250	300100250	25	35	285	320	100
280	300100280	25	45	291	320	100
315	300100315	25	35	335	370	100
355	300100355	30	30	373	430	120
400	300100400	33	42	427	482	120
450	300100450	46	14	514	585	120
500	300100500	46	24	530	585	120
560	300100560	50	10	615	685	120
630	300100630	50	30	642	685	120
710	300100710	50	20	737	800	120
800	300100800	52	18	840	905	120
900	300100900	55	15	944	1005	120
1000	3001001000	60	10	1047	1110	140

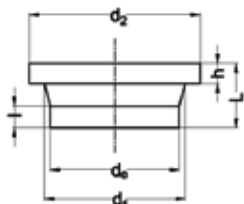

## HDPE spie-eind fittingen

- Voorlaskraag kort PE100
- SDR 11 voor stuiklas
- water 16 bar/gas 10 bar

### SDR 11

$d_0$	Art. Nr.	h	l	$d_1$	$d_2$	L
20	400100020	7	30	27	45	50
25	400100025	9	26	33	58	50
32	400100032	10	25	40	68	50
40	400100040	11	24	50	78	50
50	400100050	12	21	61	88	50
63	400100063	14	16	75	102	50
75	400100075	16	14	89	122	50
90	400100090	17	33	105	138	80
110	400100110	18	27	125	158	80
125	400100125	25	25	132	158	80
140	400100140	25	27	155	188	80
160	400100160	25	34	175	212	80
180	400100180	30	60	182	212	80
200	400100200	32	36	232	268	100
225	400100225	32	46	235	268	100
250	400100250	35	35	285	320	100
280	400100280	35	45	291	320	100
315	400100315	35	35	335	370	100
355	400100355	40	30	373	430	120
400	400100400	46	29	427	482	120
450	400100450	60	20	514	585	120
500	400100500	60	20	530	585	120
560	400100560	60	30	615	685	120
630	400100630	60	20	642	685	120
710	400100710	67	20	737	800	120
800	47 80 02 511	74	20	840	905	120

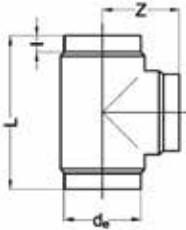

## HDPE spie-eind fittingen

- T-stuk 90° kort PE100
- SDR 17 voor stuiklas
- water 10 bar/gas 5 bar

SDR 17				
$d_e$	Art. Nr.	L	Z	I
40	300300040	88	44	16
50	300300050	116	58	21
63	300300063	146	73	24
75	300300075	170	85	28
90	300300090	200	100	23
110	300300110	240	120	43
125	300300125	250	125	26
140	300300140	280	140	32
160	300300160	350	160	40
180	300300180	390	195	73
200	300300200	430	215	64
225	300300225	490	245	72
250	300300250	550	275	86
280	300300280	620	310	105
315	300300315	700	350	111
355	300300355	680	340	101
400	300300400	680	338	95
450	300300450	900	450	130
500	300300500	900	450	130



## HDPE spie-eind fittingen

- T-stuk 90° kort PE100
- SDR 11 voor stuiklas
- water 16 bar/gas 10 bar

SDR 11				
$d_e$	Art. Nr.	L	Z	I
20	400300020	50	25	8
25	400300025	60	30	10
32	400300032	80	40	12
40	400300040	88	44	16
50	400300050	116	58	21
63	400300063	146	73	24
75	400300075	170	85	28
90	400300090	200	100	23
110	400300110	240	120	43
125	400300125	250	125	26
140	400300140	280	140	32
160	400300160	350	160	40
180	400300180	390	195	73
200	400300200	430	215	64
225	400300225	490	245	72
250	400300250	550	275	86
280	400300280	620	310	105
315	400300315	700	350	111
355	400300355	680	340	101
400	400300400	680	338	95
450	400300450	900	450	130
500	400300500	900	450	130

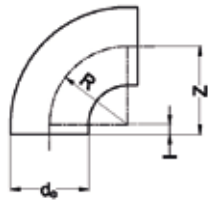

## HDPE spie-eind fittingen

- Bocht 90° kort PE100
- SDR 17 voor stuiklas
- water 10 bar/gas 5 bar

SDR 17				
$d_e$	Art. Nr.	Z	I	R
40	30020004090	51	7	44
50	30020005090	62	7	55
63	30020006390	77	8	69
75	30020007590	85	10	75
90	30020009090	100	10	90
110	30020011090	120	10	110
125	30020012590	140	15	125
140	30020014090	155	15	140
160	30020016090	175	15	160
180	30020018090	195	15	180
200	30020020090	215	15	200
225	30020022590	245	20	225
250	30020025090	275	25	250
280	30020028090	310	30	280
315	30020031590	350	35	315
355	30020035590	340	40	300
400	30020040090	350	50	300
450	30020045090	450	50	400
500	30020050090	450	50	400

$R \approx 1 \times d_e$

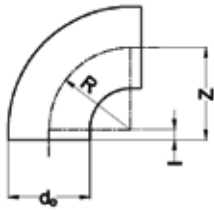

## HDPE spie-eind fittingen

- Bocht 90° kort PE100
- SDR 11 voor stuiklas
- water 16 bar/gas 10 bar

SDR 11				
$d_e$	Art. Nr.	Z	l	R
20	40020002090	27	3	24
25	40020002590	32	5	27
32	40020003290	40	5	35
40	40020004090	51	7	44
50	40020005090	62	7	55
63	40020006390	77	8	69
75	40020007590	85	10	75
90	40020009090	100	10	90
110	40020011090	120	10	110
125	40020012590	140	15	125
140	40020014090	155	15	140
160	40020016090	175	15	160
180	40020018090	195	15	180
200	40020020090	215	15	200
225	40020022590	245	20	225
250	40020025090	275	25	250
280	40020028090	310	30	280
315	40020031590	350	35	315
355	40020035590	340	40	300
400	40020040090	350	50	300
450	40020045090	450	50	400
500	40020050090	450	50	400

$R \approx 1 \times d_e$

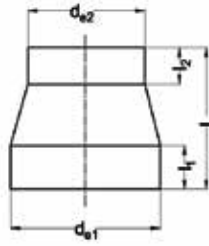

## HDPE spie-eind fittingen

- Verloopstuk concentrisch kort PE100
- SDR 17 voor stuiklas
- water 10 bar/gas 5 bar

SDR 17				
d <sub>e1</sub> /d <sub>e2</sub>	Art. Nr.	L	l <sub>1</sub>	l <sub>2</sub>
50/32	300500050032	55	12	12
50/40	300500050040	55	12	12
63/32	300500063032	65	16	12
63/40	300500063040	65	16	12
63/50	300500063050	65	16	12
75/32	300500075032	80	19	12
75/40	300500075040	71	19	12
75/50	300500075050	71	19	12
75/63	300500075063	71	19	16
90/50	300500090050	80	22	12
90/63	300500090063	80	22	16
90/75	300500090075	80	22	19
110/50	300500110050	105	28	12
110/63	300500110063	97	28	16
110/75	300500110075	97	28	19
110/90	300500110090	97	28	22
125/63	300500125063	112	30	16
125/75	300500125075	108	32	19
125/90	300500125090	108	32	22
125/110	300500125110	108	32	28
140/75	300500140075	123	35	19
140/90	300500140090	115	35	22
140/110	300500140110	115	35	28
140/125	300500140125	115	35	32
160/90	300500160090	135	40	22
160/110	300500160110	124	40	28
160/125	300500160125	124	40	32
160/140	300500160140	124	40	35
180/90	300500180090	157	45	22
180/110	300500180110	157	45	28
180/125	300500180125	136	45	32
180/140	300500180140	136	45	35
180/160	300500180160	136	45	40
200/140	300500200140	154	50	35
200/160	300500200160	151	50	40
200/180	300500200180	151	50	45

$d_{e1}/d_{e2}$	Art. Nr.	L	$l_1$	$l_2$
225/140	300500225140	160	60	50
225/160	300500225160	171	55	40
225/180	300500225180	171	55	45
225/200	300500225200	171	55	50
250/160	300500250160	194	60	40
250/180	300500250180	182	60	45
250/200	300500250200	182	60	50
250/225	300500250225	182	60	55
280/200	300500280200	200	85	70
280/225	300500280225	200	85	72
280/250	300500280250	200	85	80
315/200	300500315200	230	95	85
315/225	300500315225	230	95	88
315/250	300500315250	230	95	95
315/280	300500315280	230	95	107



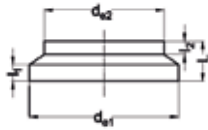

## HDPE spie-eind fittingen

- Verloopstuk concentrisch kort PE100
- SDR 11 voor stuiklas
- water 16 bar/gas 10 bar

SDR 11				
$d_{e1}/d_{e2}$	Art. Nr.	L	$l_1$	$l_2$
355/200	400500355200	160	57	40
355/225	400500355225	140	57	40
355/250	400500355250	130	54	40
355/280	400500355280	120	53	40
355/315	400500355315	110	53	40
400/225	400500400225	160	64	40
400/250	400500400250	150	61	40
400/280	400500400280	140	60	40
400/315	400500400315	120	50	40
400/355	400500400355	110	51	40
450/280	400500450280	160	65	40
450/315	400500450315	140	55	40
450/355	400500450355	130	57	40
450/400	400500450400	120	60	40
500/280	400500500280	180	80	40
500/315	400500500315	170	71	40
500/355	400500500355	150	62	40
500/400	400500500400	140	65	40
500/450	400500500450	120	60	40
560/355	400500560355	170	75	40
560/400	400500560400	160	68	40
560/450	400500560450	140	62	40
560/500	400500560500	130	67	40
630/355	400500630355	200	80	40
630/400	400500630400	190	78	40
630/450	400500630450	170	72	40
630/500	400500630500	150	67	40
630/560	400500630560	130	64	40

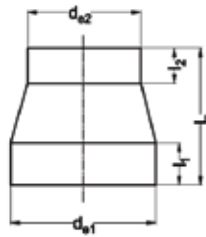

## HDPE spie-eind fittingen

- Verloopstuk concentrisch kort PE100
- SDR 11 voor stuiklas
- water 16 bar/gas 10 bar

### SDR 11

$d_{e1}/d_{e2}$	Art. Nr.	L	$l_1$	$l_2$
25/20	400500025020	37	12	12
32/20	400500032020	43	12	12
32/25	400500032025	43	12	12
40/20	400500040020	50	12	12
40/25	400500040025	50	12	12
40/32	400500040032	50	12	12
50/25	400500050025	55	12	12
50/32	400500050032	55	12	12
50/40	400500050040	55	12	12
63/32	400500063032	65	16	12
63/40	400500063040	65	16	12
63/50	400500063050	65	16	12
75/32	400500075032	80	19	12
75/40	400500075040	71	19	12
75/50	400500075050	71	19	12
75/63	400500075063	71	19	16
90/50	400500090050	80	22	12
90/63	400500090063	80	22	16
90/75	400500090075	80	22	19
110/50	400500110050	105	28	12
110/63	400500110063	97	28	16
110/75	400500110075	97	28	19
110/90	400500110090	97	28	22
125/63	400500125063	112	30	16
125/75	400500125075	108	32	19
125/90	400500125090	108	32	22
125/110	400500125110	108	32	28
140/75	400500140075	123	35	19
140/90	400500140090	115	35	22
140/110	400500140110	115	35	28
140/125	400500140125	115	35	32
160/90	400500160090	135	40	22
160/110	400500160110	124	40	28
160/125	400500160125	124	40	32
160/140	400500160140	124	40	35

$d_{e1}/d_{e2}$	Art. Nr.	L	$l_1$	$l_2$
180/90	400500180090	157	45	22
180/110	400500180110	157	45	28
180/125	400500180125	136	45	32
180/140	400500180140	136	45	35
180/160	400500180160	136	45	40
200/140	400500200140	154	50	35
200/160	400500200160	151	50	40
200/180	400500200180	151	50	45
225/140	400500225140	160	60	50
225/160	400500225160	171	55	40
225/180	400500225180	171	55	45
225/200	400500225200	171	55	50
250/160	400500250160	194	60	40
250/180	400500250180	182	60	45
250/200	400500250200	182	60	50
250/225	400500250225	182	60	55
280/200	400500280200	200	85	70
280/225	400500280225	200	85	72
280/250	400500280250	200	85	80
315/200	400500315200	230	95	85
315/225	400500315225	230	95	88
315/250	400500315250	230	95	95
315/280	400500315280	230	95	107

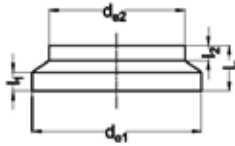

## HDPE spie-eind fittingen

- Verloopstuk concentrisch kort PE100
- SDR 17 voor stuiklas
- water 10 bar/gas 5 bar

### SDR 17

$d_{e1}/d_{e2}$	Art. Nr.	L	$l_1$	$l_2$
355/200	300500355200	160	57	40
355/225	300500355225	140	57	40
355/250	300500355250	130	54	40
355/280	300500355280	120	53	40
355/315	300500355315	110	53	40
400/225	300500400225	160	64	40
400/250	300500400250	150	61	40
400/280	300500400280	140	60	40
400/315	300500400315	120	50	40
400/355	300500400355	110	51	40
450/280	300500450280	160	65	40
450/315	300500450315	140	55	40
450/355	300500450355	130	57	40
450/400	300500450400	120	60	40
500/280	300500500280	180	80	40
500/315	300500500315	170	71	40
500/355	300500500355	150	62	40
500/400	300500500400	140	65	40
500/450	300500500450	120	60	40
560/355	300500560355	170	75	40
560/400	300500560400	160	68	40
560/450	300500560450	140	62	40
560/500	300500560500	130	67	40
630/355	300500630355	200	80	40
630/400	300500630400	190	78	40
630/450	300500630450	170	72	40
630/500	300500630500	150	67	40
630/560	300500630560	130	64	40
710/500	300500710500	130	84	40
710/560	300500710560	170	81	40
710/630	300500710630	140	71	40
800/560	300500800560	200	85	40
800/630	300500800630	180	85	40
800/710	300500800710	150	78	40
900/630	300500900630	220	96	40
900/710	300500900710	190	89	40
900/800	300500900800	160	85	40
1000/710	3005001000710	220	101	40
1000/800	3005001000800	180	86	40
1000/900	3005001000900	140	75	40

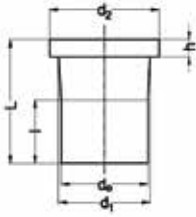

## HDPE spie-eind fittingen

- Voorlaskraag lang PE100
- SDR 17 voor stuijk- en elektrolas
- water 10 bar/gas 5 bar

SDR 17						
$d_e$	Art. Nr.	h	l	$d_1$	$d_2$	L
63	100450063	14	66	75	102	120
75	100450075	18	78	89	122	130
90	100450090	18	84	105	138	145
110	100450110	18	100	125	158	155
125	100450125	18	108	132	158	170
140	100450140	18	109	155	188	195
160	100450160	18	110	175	212	195
180	100450180	20	115	180	212	200
200	100450200	24	127	232	268	205
225	100450225	24	137	235	268	205
250	100450250	25	146	285	320	205
280	100450280	25	156	291	320	220
315	100450315	25	160	335	370	225
355	100450355	30	175	373	430	260
400	100450400	33	195	427	482	285
450	100450450	46	280	519	585	400
500	100450500	46	280	530	585	400
560	100450560	50	280	615	685	400
630	100450630	50	280	624	685	400
710	100450710	50	280	737	800	400
800	100450800	52	280	840	905	400
900	100450900	55	280	944	1005	400
1000	1004501000	60	260	1047	1110	400

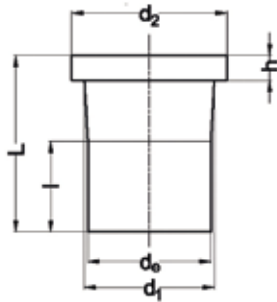

## HDPE spie-eind fittingen

- Voorlaskraag lang PE100
- SDR 11 voor stuijk- en elektroslas
- water 16 bar/gas 10 bar

SDR 11						
$d_e$	Art. Nr.	h	l	$d_1$	$d_2$	L
20	100400020	7	64	27	45	88
25	100400025	9	51	33	58	90
32	100400032	11	57	40	68	95
40	100400040	12	55	50	78	100
50	100400050	12	63	61	88	110
63	100400063	15	66	75	102	120
75	100400075	17	78	89	122	130
90	100400090	18	84	105	138	145
110	100400110	18	115	125	158	155
125	100400125	25	125	132	158	170
140	100400140	25	109	155	188	195
160	100400160	25	140	175	212	195
180	100400180	31	115	182	212	200
200	100400200	32	127	232	268	205
225	100400225	33	137	235	268	205
250	100400250	35	130	285	320	205
280	100400280	35	156	291	320	220
315	100400315	35	155	335	370	225
355	100400355	40	175	373	430	255
400	100400400	46	195	427	482	285
450	100400450	60	280	514	585	400
500	100400500	60	280	530	585	400
560	100400560	60	280	615	685	400
630	100400630	60	280	624	685	400
710	100400710	67	280	737	800	400

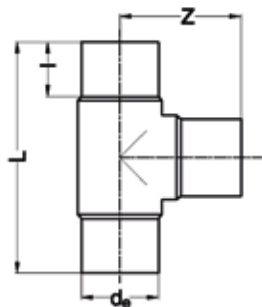

## HDPE spie-eind fittingen

- T-stuk 90° lang PE100
- SDR 17 voor stuijk- en elektrolas
- water 10 bar/gas 5 bar

SDR 17				
$d_e$	Art. Nr.	L	Z	I
63	300420063	228	114	70
75	300420075	240	120	73
90	300420090	306	153	86
110	300420110	336	168	95
125	300420125	354	177	100
140	300420140	386	193	105
160	300420160	450	225	124
180	300420180	466	233	119
200	300420200	502	251	127
225	300420225	554	272	138
250	300420250	628	314	148
280	300420280	692	346	160
315	300420315	760	380	170
355	300420355	820	410	165
400	300420400	915	460	195
450	300420450	970	485	195
500	300420500	1060	530	215

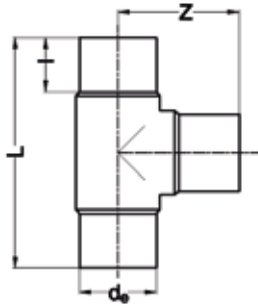

## HDPE spie-eind fittingen

- T-stuk 90° lang PE100
- SDR 11 voor stui- en elektroglas
- water 16 bar/gas 10 bar

### SDR 11

$d_e$	Art. Nr.	L	Z	I
20	100420020	107	54	35
25	100420025	124	62	41
32	100420032	150	75	51
40	100420040	164	82	55
50	100420050	166	83	51
63	100420063	228	114	70
75	100420075	240	120	73
90	100420090	306	153	86
110	100420110	336	168	95
125	100420125	354	177	100
140	100420140	386	193	105
160	100420160	450	225	124
180	100420180	466	233	119
200	100420200	502	251	127
225	100420225	554	272	138
250	100420250	628	314	148
280	100420280	692	346	160
315	100420315	760	380	170
355	100420355	820	410	165
400	100420400	915	460	195
450	100420450	970	485	195
500	100420500	1060	530	215



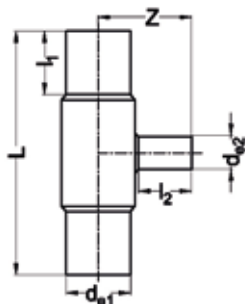

## HDPE spie-eind fittingen

- T-stuk 90° verlopend lang PE100
- met gereduceerde aftakking SDR 11
- voor stuike- en elektrode
- water 16 bar/gas 10 bar

SDR 11					
$d_{e1}/d_{e2}$	Art. Nr.	L	Z	$l_1$	$l_2$
63/32	400600063032	228	91	70	46
63/50	400600063050	213	100	63	56
75/50	400600075050	253	113	70	55
75/63	400600075063	252	117	70	63
90/50	400600090050	275	117	79	55
90/63	400600090063	264	134	79	63
90/75	400600090075	272	138	74	70
110/63	400600110063	316	135	88	62
110/75	400600110075	305	154	82	70
110/90	400600110090	310	155	91	78
125/63	400600125063	358	148	100	63
125/75	400600125075	358	155	100	76
125/90	400600125090	330	168	110	91
125/110	400600125110	340	170	87	82
140/63	400600140063	386	160	105	77
140/75	400600140075	386	173	105	78
140/90	400600140090	388	182	105	87
140/110	400600140110	388	188	105	95
160/63	400600160063	424	174	110	72
160/75	400600160075	424	180	111	73
160/90	400600160090	424	190	111	84
160/110	400600160110	424	197	111	93
180/75	400600180075	460	190	116	93
180/90	400600180090	460	200	116	85
180/110	400600180110	420	200	116	95
180/125	400600180125	430	215	116	100
180/140	400600180140	460	220	116	104
180/160	400600180160	460	225	116	110
200/63	400600200063	550	225	134	80
200/75	400600200075	450	200	127	70
200/90	400600200090	550	227	134	95
200/110	400600200110	550	240	134	103
200/125	400600200125	550	240	134	110
200/160	400600200160	550	265	134	114
225/63	400600225063	540	241	130	69

$d_{e1}/d_{e2}$	Art. Nr.	L	Z	$l_1$	$l_2$
225/75	400600225075	540	248	130	76
225/90	400600225090	440	224	120	80
225/110	400600225110	522	271	120	92
225/125	400600225125	522	266	120	93
225/140	400600225140	540	276	130	104
225/160	400600225160	522	252	120	109
225/180	400600225180	552	280	131	131
250/110	400600250110	575	242	130	82
250/160	400600250160	575	261	130	98
250/200	400600250200	625	290	148	116
315/90	400600315090	545	290	170	90
315/110	400600315110	546	290	170	100
315/160	400600315160	575	310	170	120
315/200	400600315200	640	330	170	130
315/225	400600315225	638	335	170	145
315/250	400600315250	670	333	170	150

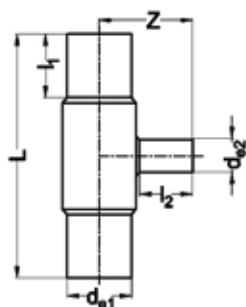

## HDPE spie-eind fittingen

- T-stuk 90° verlopend lang PE100
- met gereduceerde aftakking SDR 17
- voor stui- en elektroslas
- water 10 bar/gas 5 bar

SDR 17					
d <sub>e1</sub> /d <sub>e2</sub>	Art. Nr.	L	Z	l <sub>1</sub>	l <sub>2</sub>
63/32	300600063032	228	91	70	46
63/50	300600063050	213	100	63	56
75/50	300600075050	253	113	70	55
75/63	300600075063	252	117	70	63
90/50	300600090050	275	117	79	55
90/63	300600090063	264	134	79	63
90/75	300600090075	272	138	74	70
110/63	300600110063	316	135	88	62
110/75	300600110075	305	148	82	70
110/90	300600110090	310	155	91	78
125/63	300600125063	358	148	100	69
125/75	300600125075	358	155	100	76
125/90	300600125090	358	164	100	85
125/110	300600125110	340	170	87	82
140/63	300600140063	386	160	105	77
140/75	300600140075	386	173	105	78
140/90	300600140090	388	182	105	87
140/110	300600140110	388	188	105	95
160/63	300600160063	424	174	110	72
160/75	300600160075	424	180	111	73
160/90	300600160090	424	190	111	84
160/110	300600160110	424	197	111	93
180/75	300600180075	460	190	116	93
180/90	300600180090	420	200	116	85
180/110	300600180110	460	210	116	95
180/125	300600180125	430	215	116	100
180/140	300600180140	460	220	116	104
180/160	300600180160	460	225	116	110
200/63	300600200063	550	225	134	80
200/75	300600200075	450	200	127	70
200/90	300600200090	550	227	134	95
200/110	300600200110	550	240	134	103
200/125	300600200125	550	240	134	110
200/160	300600200160	550	265	134	114
225/63	300600225063	540	241	130	69
225/75	300600225075	440	226	120	80

$d_{e1}/d_{e2}$	Art. Nr.	L	Z	$l_1$	$l_2$
225/90	300600225090	440	224	120	80
225/110	300600225110	522	271	120	92
225/125	300600225125	522	266	120	93
225/140	300600225140	540	276	130	104
225/160	300600225160	522	252	120	109
225/180	300600225180	552	280	131	131
250/110	300600250110	575	242	130	82
250/160	300600250160	575	261	130	98
250/200	300600250200	625	290	148	116
315/90	300600315090	545	290	170	90
315/110	300600315110	546	290	170	100
315/160	300600315160	575	310	170	120
315/200	300600315200	640	330	170	130
315/225	300600315225	640	335	170	145
315/250	300600315250	638	340	170	150

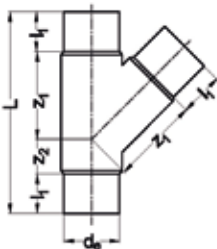

## HDPE spie-eind fittingen

- T-stuk 45° lang PE100
- SDR 17 voor stuijk- en elektroslas
- water 10 bar/gas 5 bar

### SDR 17

$d_e$	Art. Nr.	L	$l_1$	$Z_1$	$Z_2$
50	30044045050	223	55	75	40
63	30044045063	245	63	93	23
75	30044045075	290	75	103	37
90	30044045090	370	85	148	51
110	30044045110	400	85	164	66
125	30044045125	440	105	185	45
160	30044045160	540	115	260	50
180	30044045180	575	116	268	75
200	30044045200	625	122	287	94
225	30044045225	705	135	350	85

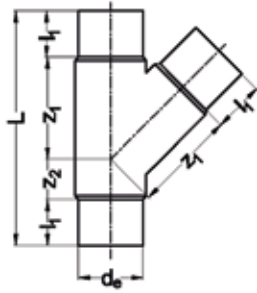

## HDPE spie-eind fittingen

- T-stuk 45° lang PE100
- SDR 11 voor stuik- en elektrolas
- water 16 bar/gas 10 bar

### SDR 11

$d_0$	Art. Nr.	L	$l_1$	$Z_1$	$Z_2$
40	10044045040	185	45	75	40
50	10044045050	223	55	90	23
63	10044045063	245	63	93	23
75	10044045075	290	75	101	37
90	10044045090	370	85	148	51
110	10044045110	400	85	164	66
125	10044045125	440	105	185	45
160	10044045160	540	110	260	50
180	10044045180	575	116	268	75
200	10044045200	625	122	287	94
225	10044045225	705	135	350	85

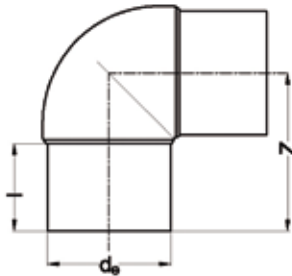

## HDPE spie-eind fittingen

- Knie 90° lang PE100
- SDR 17 voor stuik- en elektrolas
- water 10 bar/gas 5 bar

### SDR 17

$d_0$	Art. Nr.	Z	l
63	30041006390	95	56
75	30041007590	116	72
90	30041009090	139	78
110	30041011090	158	86
125	30041012590	180	104
140	30041014090	198	119
160	30041016090	210	117
180	30041018090	222	116
200	30041020090	250	128
225	30041022590	269	136
250	30041025090	307	180
280	30041028090	340	200
315	30041031590	370	210

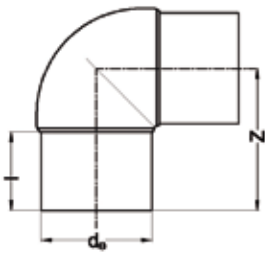

## HDPE spie-eind fittingen

- Knie 90° lang PE100
- SDR 11 voor stuijk- en elektrolas
- water 16 bar/gas 10 bar

### SDR 11

$d_e$	Art. Nr.	Z	l
20	10041002090	70	60
25	10041002590	63	42
32	10041003290	72	47
40	10041004090	69	44
50	10041005090	77	50
63	10041006390	95	56
75	10041007590	116	72
90	10041009090	139	78
110	10041011090	158	86
125	10041012590	180	104
140	10041014090	198	119
160	10041016090	210	117
180	10041018090	222	116
200	10041020090	250	128
225	10041022590	269	136
250	10041025090	307	180
280	10041028090	340	200
315	10041031590	370	210

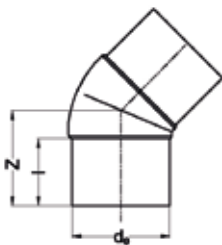

## HDPE spie-eind fittingen

- Knie 45° lang PE100
- SDR 17 voor stuijk- en elektrolas
- water 10 bar/gas 5 bar

### SDR 17

$d_e$	Art. Nr.	Z	l
63	30041006345	82	56
75	30041007545	96	75
90	30041009045	120	84
110	30041011045	129	91
125	30041012545	147	101
140	30041014045	153	104
160	30041016045	169	113
180	30041018045	186	120
200	30041020045	201	127
225	30041022545	218	134
250	30041025045	217	155
280	30041028045	232	162
315	30041031545	251	173

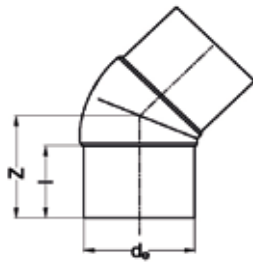

## HDPE spie-eind fittingen

- Knie 45° lang PE100
- SDR 11 voor stuik- en elektrolas
- water 16 bar/gas 10 bar

### SDR 11

$d_e$	Art. Nr.	Z	I
20	10041002045	44	39
25	10041002545	41	35
32	10041003245	48	47
40	10041004045	58	44
50	10041005045	74	54
63	10041006345	82	56
75	10041007545	96	75
90	10041009045	120	84
110	10041011045	129	91
125	10041012545	147	101
140	10041014045	153	104
160	10041016045	169	113
180	10041018045	186	120
200	10041020045	201	127
225	10041022545	218	134
250	10041025045	217	155
280	10041028045	232	162
315	10041031545	251	173

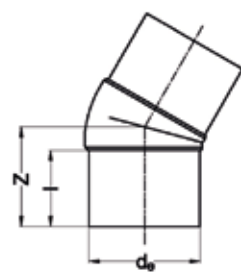

## HDPE spie-eind fittingen

- Knie 30° lang PE100
- SDR 17 voor stuik- en elektrolas
- water 10 bar/gas 5 bar

### SDR 17

$d_e$	Art. Nr.	Z	I
75	30041007530	108	77
90	30041009030	116	85
110	30041011030	130	96
125	30041012530	143	102
140	30041014030	148	110
160	30041016030	154	108
180	30041018030	160	116
200	30041020030	170	122
225	30041022530	185	129

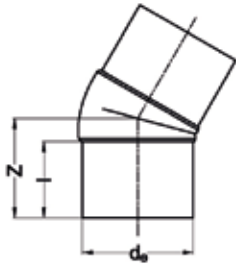

## HDPE spie-eind fittingen

- Knie 30° lang PE100
- SDR 11 voor stuijk- en elektrolass
- water 16 bar/gas 10 bar

### SDR 11

$d_e$	Art. Nr.	Z	l
75	10041007530	108	77
90	10041009030	116	85
110	10041011030	130	96
125	10041012530	143	102
140	10041014030	148	110
160	10041016030	154	108
180	10041018030	160	116
200	10041020030	170	122
225	10041022530	185	129





## HDPE gedraaide bochten,

- PE 100, verlengde uitvoering  
(beide zijden verlengd met 500 mm buis, kleur zwart)

SDR 17	
Artikelnummer:	Dia.
30020511011z	110 mm
30020512511z	125 mm
30020514011z	140 mm
30020516011z	160 mm
30020518011z	180 mm
30020520011z	200 mm
30020522511z	225 mm
30020525011z	250 mm
30020528011z	280 mm
30020531511z	315 mm
30020535511z	355 mm
30020540011z	400 mm

SDR 11	
Artikelnummer	Dia.
35020511011z	110 mm
35020512511z	125 mm
35020514011z	140 mm
35020516011z	160 mm
35020518011z	180 mm
35020520011z	200 mm
35020522511z	225 mm
35020525011z	250 mm
35020528011z	280 mm
35020531511z	315 mm
35020535511z	355 mm
35020540011z	400 mm

## HDPE gedraaide bochten,

- PE 100, verlengde uitvoering t.b.v gasdistributie



SDR 17,6 (max. 4 bar gas)	
(beide zijden verlengd met 500 mm buis, kleur zwart met gele strepen in lengterichting)	
Artikelnummer:	Dia.
30020511011	110 mm
30020512511	125 mm
30020514011	140 mm
30020516011	160 mm
30020518011	180 mm
30020520011	200 mm
30020522511	225 mm
30020525011	250 mm
30020528011	280 mm
30020531511	315 mm
30020535511	355 mm
30020540011	400 mm



SDR 11 (8 bar gas)	
(beide zijden verlengd met 500 mm buis, kleur zwart)	
Artikelnummer	Dia.
35020511011	110 mm
35020512511	125 mm
35020514011	140 mm
35020516011	160 mm
35020518011	180 mm
35020520011	200 mm
35020522511	225 mm
35020525011	250 mm
35020528011	280 mm
35020531511	315 mm
35020535511	355 mm
35020540011	400 mm

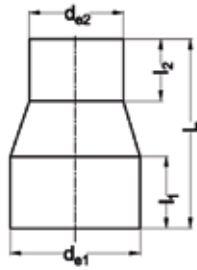

## HDPE spie-eind fittingen

- Verloopstuk concentrisch lang PE100
- SDR 17 voor stui- en elektrolas
- water 10 bar/gas 5 bar

### SDR 17

$d_{e1}/d_{e2}$	Art. Nr.	L	$l_1$	$l_2$
50/25	300550050025	130	55	40
50/32	300550050032	132	55	44
50/40	300550050040	8,14	55	49
63/32	300550063032	146	63	44
63/40	300550063040	150	63	49
63/50	300550063050	150	63	55
75/63	300550075063	147	66	63
90/50	300550090050	142	64	49
90/63	300550090063	144	69	55
90/75	300550090075	163	74	65
110/63	300550110063	174	85	63
110/75	300550110075	180	85	57
110/90	300550110090	179	79	74
125/63	300550125063	187	87	61
125/75	300550125075	205	105	76
125/90	300550125090	216	99	86
125/110	300550125110	201	89	84
140/75	300550140075	230	112	70
140/90	300550140090	230	112	79
140/110	300550140110	230	112	82
140/125	300550140125	214	99	92
160/90	300550160090	216	101	72
160/110	300550160110	223	104	84
160/125	300550160125	227	95	91
160/140	300550160140	217	110	95
180/90	300550180090	237	105	79
180/110	300550180110	270	120	92
180/125	300550180125	278	116	103
180/140	300550180140	270	120	110
180/160	300550180160	277	115	114
200/125	300550200125	283	123	103
200/140	300550200140	275	120	110
200/160	300550200160	253	105	100
200/180	300550200180	272	120	115
225/110	300550225110	312	130	94
225/140	300550225140	295	130	110
225/160	300550225160	312	130	109
225/180	300550225180	310	130	111
225/200	300550225200	272	124	115

$d_{e1}/d_{e2}$	Art. Nr.	L	$I_1$	$I_2$
250/160	300550250160	339	138	111
250/180	300550250180	338	137	123
250/200	300550250200	337	137	127
250/225	300550250225	337	146	137
280/180	300550280180	350	146	119
280/200	300550280200	350	146	124
280/225	300550280225	350	146	129
280/250	300550280250	350	146	134
315/200	300550315200	380	180	134
315/225	300550315225	380	157	133
315/250	300550315250	380	157	138
315/280	300550315280	380	157	148
355/250	300550355250	415	172	143
355/280	300550355280	415	172	148
355/315	45 35 31 517	415	172	158
400/280	45 40 28 517	450	187	153
400/315	45 40 31 517	450	187	158
400/355	45 40 35 517	450	187	168

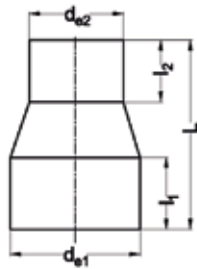

## HDPE spie-eind fittingen

- Verloopstuk concentrisch lang PE100
- SDR 11 voor stuike- en elektroslas
- water 16 bar/gas 10 bar

### SDR 11

$d_{e1}/d_{e2}$	Art. Nr.	L	$l_1$	$l_2$
25/20	100550025020	87	40	41
32/20	100550032020	92	43	39
32/25	100550032025	89	44	37
40/20	100550040020	94	45	36
40/25	100550040025	96	47	35
40/32	100550040032	93	50	39
50/25	100550050025	136	62	48
50/32	100550050032	134	61	50
50/40	100550050040	134	61	56
63/32	100550063032	150	69	50
63/40	100550063040	152	69	55
63/50	100550063050	151	69	60
75/50	100550075050	148	64	58
75/63	100550075063	149	65	59
90/50	100550090050	142	64	49
90/63	100550090063	144	69	55
90/75	100550090075	163	76	61
110/63	100550110063	174	85	63
110/75	100550110075	180	85	57
110/90	100550110090	179	99	93
125/63	100550125063	187	87	61
125/75	100550125075	205	105	76
125/90	100550125090	216	99	86
125/110	100550125110	200	90	82
140/75	100550140075	230	112	70
140/90	100550140090	230	112	79
140/110	100550140110	230	112	82
140/125	100550140125	211	96	90
160/90	100550160090	217	102	74
160/110	100550160110	223	104	84
160/125	100550160125	231	98	92
160/140	100550160140	217	110	95
180/90	100550180090	237	105	79
180/110	100550180110	270	120	92
180/125	100550180125	278	116	103
180/140	100550180140	270	120	110
180/160	100550180160	277	115	114
200/125	100550200125	283	123	103
200/140	100550200140	275	120	110
200/160	100550200160	252	105	100

$d_{e1}/d_{e2}$	Art. Nr.	L	$I_1$	$I_2$
200/180	100550200180	272	120	115
225/110	100550225110	312	130	94
225/140	100550225140	295	130	110
225/160	100550225160	312	130	109
225/180	100550225180	310	130	111
225/200	100550225200	272	124	115
250/160	100550250160	339	138	111
250/180	100550250180	338	137	123
250/200	100550250200	337	137	127
250/225	100550250225	337	137	137
280/180	100550280180	350	146	119
280/200	100550280200	350	146	124
280/225	100550280225	350	146	129
280/250	100550280250	350	146	134
315/200	100550315200	380	180	134
315/225	100550315225	380	157	133
315/250	100550315250	380	157	138
315/280	100550315280	380	157	148
355/250	100550355250	415	172	143
355/280	100550355280	415	172	148
355/315	100550355315	415	172	158
400/280	100550400280	450	187	153
400/315	100550400315	450	187	158
400/355	100550400355	450	187	168

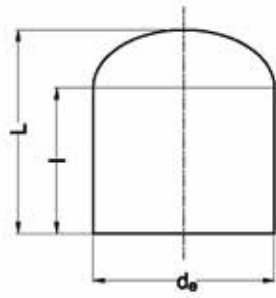

## HDPE spie-eind fittingen

- Eindkap lang PE100
- SDR 17 voor elektrolas
- water 10 bar/gas 5 bar

### SDR 17

$d_e$	Art. Nr.	L	l
63	300430063	85	62
75	300430075	95	63
90	300430090	110	79
110	300430110	127	88
125	300430125	124	95
140	300430140	140	110
160	300430160	152	121
180	300430180	169	134
200	300430200	184	140
225	300430225	200	160
250	300430250	230	152
280	300430280	257	162
315	300430315	262	167
355	300430355	270	250
400	300430400	275	250
450	300430450	285	250
500	300430500	290	275
560	300430560	300	275
630	300430630	310	300
710	300430710	320	300
800	300430800	330	300

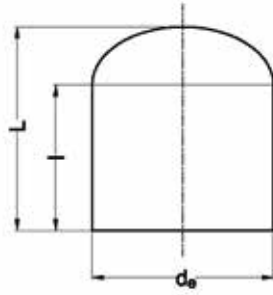

## HDPE spie-eind fittingen

- Eindkap lang PE100
- SDR 11 voor elektrolas
- water 16 bar/gas 10 bar

### SDR 11

$d_e$	Art. Nr.	L	I
20	100430020	45	35
25	100430025	52	40
32	100430032	58	44
40	100430040	67	50
50	100430050	75	55
63	100430063	85	62
75	100430075	95	63
90	100430090	110	79
110	100430110	127	88
125	100430125	124	95
140	100430140	140	110
160	100430160	152	121
180	100430180	169	134
200	100430200	184	140
225	100430225	200	160
250	100430250	230	152
280	100430280	257	162
315	100430315	262	167
355	100430355	280	250
400	100430400	285	250
450	100430450	295	250
500	100430500	305	275
560	100430560	315	275
630	100430630	325	300
710	100430710	320	300
800	100430800	330	300